



### SPECIFICATIONS

CONTACT RATING: Q: 500mA @120 VAC or 28 VDC  
 ELECTRICAL LIFE: 30,000 make-and-break cycles at full load  
 CONTACT RESISTANCE: 20 mΩ max. initial @2-4 VDC, 100 mA  
 INSULATION RESISTANCE: 1,000 MΩ min.  
 DIELECTRIC STRENGTH: 500 V RMS @ sea level.  
 OPERATING TEMPERATURE: -30°C to 85°C

### MATERIALS

Base - diallyl phthalate ( DAP ) (UL94V-0)  
 Plunger -Glass filled Nylon(UL94V-0)  
 Bushing -Copper alloy, nickel plated  
 CONTACT AND TERMINAL - Copper alloy , silver plated

### How do you build the switches you need!!

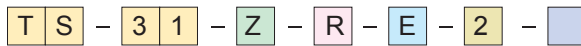

Switch Type		Terminal	Contact material	Epoxy seal	Plunger color	RoHS code
TS-31	SPST short	Z	Q silver plated	(none) none seal	1 White	<input type="checkbox"/> = none
TS-32	SPST long	C	R gold plated	E terminal seal	2 Black	H = RoHS Compliant
			G Gold over silver			

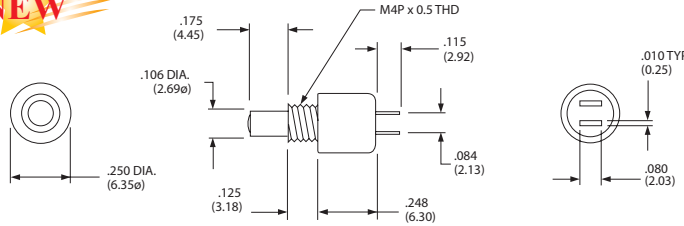

TS-31-ZR-E-2

MODEL NO.	SWITCH FUNCTION	
	POS. 1	POS. 2
TS-31	OFF	MOM.

Schematic:  
 N.O.  
 Total Travel: .040 (1.02) typ.  
 Actuation Force: 5 OZ. (140g) typ.  
 MOM = Momentary

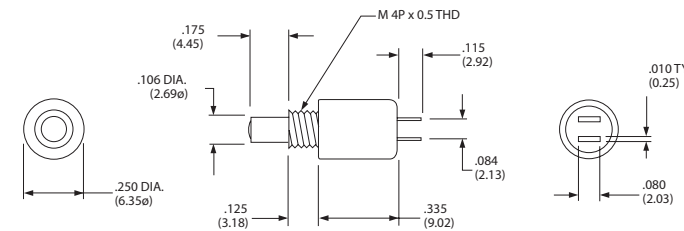

TS-32-ZR-E-2

MODEL NO.	SWITCH FUNCTION	
	POS. 1	POS. 2
TS-32	OFF	MOM.

Schematic:  
 N.O. w/Overtravel  
 Total Travel: .106 (2.69) typ. □  
 Overtravel: .024 (0.61) typ.  
 Actuation Force: 6.25 OZ. (177g) typ.  
 MOM = Momentary

### TERMINAL OPTION

### TERMINAL SEAL OPTION

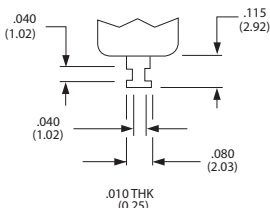

Z

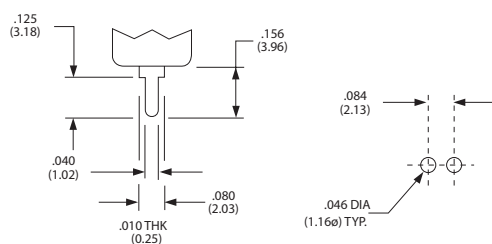

C

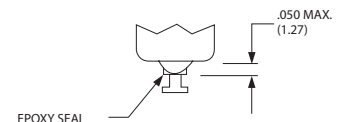

E

### CONTACT MATERIAL OPTIONS

CODE	CONTACT MATERIAL	TERMINAL MATERIAL	RATING
Q	Silver plated	Silver plated	500mA @ 120 V AC or 28 V DC
R	Gold plated over nickel plated	Gold plated over nickel plated	0.4VA MAX @ 20V AC or DC MAX
G	Gold plated over silver plated	Gold plated over silver plated	0.4 VA MAX @ 20 V AC or DC MAX or 500mA @ 120 V AC or 28 V DC